



**Road Running Technical Council  
USA Track & Field**

# **Measurement Certificate**



Name of the course NYCRUNS Prospect Park Half Marathon 2024 Distance 21.0975 km  
 Location (state) NY (city) Brooklyn  
 Type of course: Road Race  
 Measuring Methods: Bicycle  
 Measured By Matt Slocum, 199 N Fullerton, Montclair, NJ 07042, precisioncoursedesign@gmail.com, 917-725-1709  
 Race Contact Michele Gretano, NYCRUNS, mgretano@nycruns.com, 718.578.8674  
 Date(s) when course measured: 02/28/2024, 03/04/2024, 04/09/2024, 06/20/2024  
 Number of measurements of entire course: 2 Course Configuration: Loop (3x) + Partial Loop with Finish Tail  
 Elevation (meters above sea level) Start 21.00 Finish 37.00 Lowest 18.00 Highest 52.00  
 Straight line distance between start and finish 429m Drop -0.76 m/km Separation 2.03 %  
 Type of surface: Paved 100 % Dirt 0 % Gravel 0 % Grass 0 % Track 0 %  
 Effective date of certification: June 26, 2024 Certification code: NY24007MNS

Note to Race Director: Use this Certification Code in all public announcements relating to your race.

## ***Be It Officially Noted That***

Based on examination of data provided by the above named measurer, the course described above and in the map attached is hereby certified as reasonably accurate in measurement according to the standards adopted by the Road Running Technical Council. If any changes are made to the course, this certification becomes void, and the course must then be recertified.

**Verification of Course ---** In the event a National Open Record is set on the course, or at the discretion of USA Track & Field, a verification measurement may be required to be performed by a member of the Road Running Technical Council. If such a remeasurement shows the course to be short, then all pending records will be rejected and the course certification will be cancelled.

***This certification expires on December 31 of the year:*** **2034**

**AS NATIONALLY CERTIFIED BY:**



Date: June 26, 2024

Matt Slocum - USATF/RRTC Certifier - 199 N Fullerton, Montclair NJ 07042  
 (917) 725-1709 - precisioncoursedesign@gmail.com

# NYCRUNS Prospect Park Half Marathon 2024

## 21.0975 km | Brooklyn, NY



**USATF Certificate**  
 NY24007MNS  
 Effective: 06/26/2024  
 Through: 12/31/2034

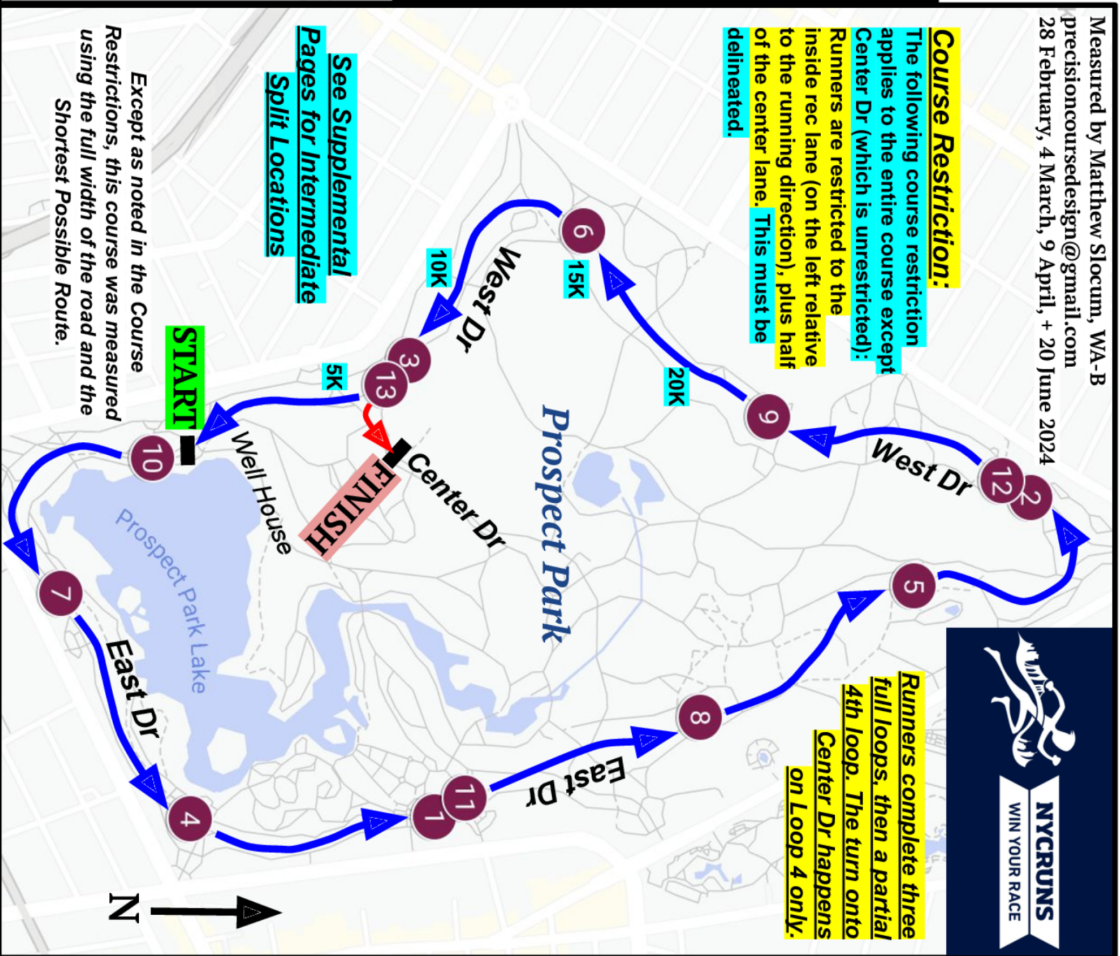
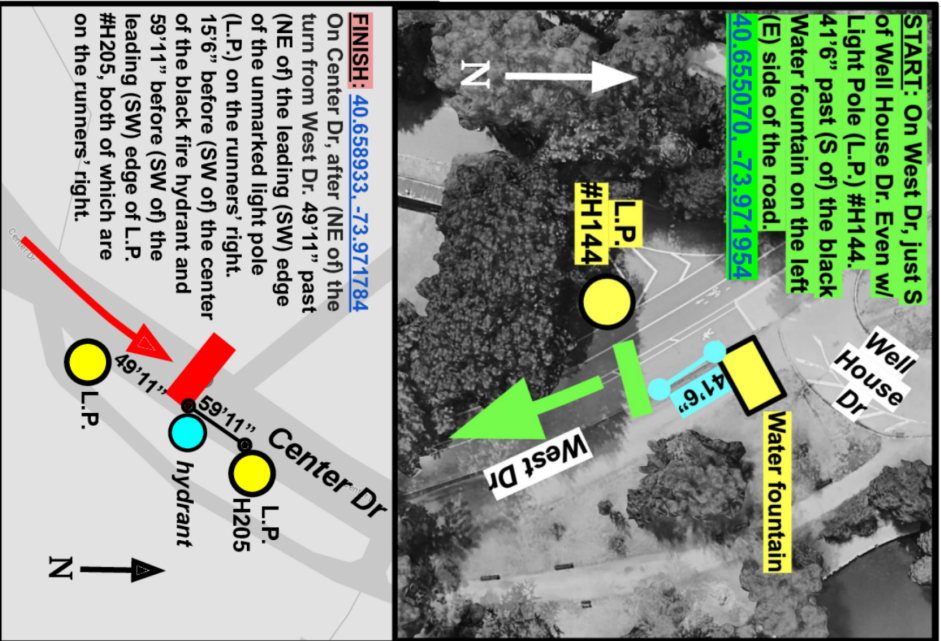

## **NYCRUNS Prospect Park Half Marathon 2024** ***Intermediate Splits***

**START:** [40.655070, -73.971954](#) | On West Dr, just S of the intersection with Well House Dr. Even with Light Pole (L.P.) #H144, which is on the right (W) side. Said L.P. is on the N side of the grass island and is the first L.P. S of Well House Dr on the W side of West Dr. 41'6" past (S of) the black water fountain on the left (E) side of the road. Marked with MagNail on the left (E) side of the road. Please see the detail diagram on the primary course map.

**Mile 1:** [40.659623, -73.963604](#) | On East Dr, N of the Concert Grove Pavilion. 5'6" after (N of) the unmarked silver L.P. on the left (W) side and 10 feet before (S of) the leading (S) edge of the metal NYC Electrical utility box in the grass (also on the runners' left).

**Mile 2:** [40.670423, -73.970889](#) | On West Dr, near the N end of the park. 44 feet past (SW of) the end (SW edge) of the wooden railing on the left (E side) of the road and 23'6" before (NE of) the unmarked black L.P. (also on the runners' left).

**Mile 3:** [40.659145, -73.974050](#) | On West Dr, before NW of Center Dr. 22 feet before (NW of) L.P. #E225, which is on the runners' right (SW side) of the road.

**5 km:** [40.657851, -73.973073](#) | On West Dr, past (S of) Center Dr. 17 feet past (S of) the leading (N) edge of the triangular grass island on the runners' right (W side), which is encircled by the road leading out of the park to Prospect Park Southwest + 16th St (aka Captain Vincent E. Brunton Way).

**Mile 4:** [40.655185, -73.963557](#) | On East Dr, before (SW of) the intersection with the Parkside Ave entrance. 50'3" before (SW of) L.P. #K227, which is on the runners' left.

**Mile 5:** [40.668313, -73.968904](#) | On East Drive, before (S of) *The Vale of Cashmere* and just before (S of) the cutout. 38 feet before (S of) L.P. #P136 (on the runners' right). Said L.P. is the final L.P. before the cutout. Even with the metal utility box in the road, which is also on the runners' right. 67 feet after (N of) the unmarked silver L.P. on the runners' left.

**Mile 6:** [40.662315, -73.976988](#) | On West Dr, roughly even with 12th St (following the SE angle of 12th St). 6 feet past (SW of) the black fire hydrant on the runners' left and 28 feet past the trailing (SW) edge of the storm drain (also on the runners' left). 10'5" past (SW of) L.P. #B143, which is on the runners' right.

**10 km:** [40.660087, -73.975787](#) | On West Dr, even with the traffic signal on the runners' right at the trailing (SE) side of the crosswalk and opening for the path. Said path connects from the ballfields to Prospect Park Southwest.

**Mile 7:** [40.652837, -73.968704](#) | On East Dr, before (SW of) *The Peristyle*. 41 feet before (SW of) L.P. #K129, which is on the runners' right. Even with the large tree next to the curb and 19 feet past (NE of) the black fire hydrant (both on the runners' left).

**Mile 8:** [40.664418, -73.965886](#) | On East Drive, near the *Prospect Park Zoo*. 8'3" before (S of) the unmarked silver L.P. on the runners' right and 109 feet past (N of) L.P. #106 (on the runners' left).

**Mile 9:** [40.665654, -73.972756](#) | On West Drive, near *The Picnic House*. Even with the trailing (S) edge of the sidewalk on the runners' right. 5'6" before (N of) L.P. #T2 (on the runners' right). Said L.P. may be missing some digits.

*Continued on next page*

**15 km:** [40.662315, -73.976988](#) | On West Dr, 7 feet past (SW of) Mile 6. 13 feet past (SW of) the black fire hydrant on the runners' left, 35 feet past the trailing (SW) edge of the storm drain (also on the runners' left), and 17'5" past L.P. #B143, which is on the runners' right.

**Mile 10:** [40.654505, -73.971803](#) | On West Drive, past (S of) Well House. 37 feet past (S of) L.P. #H141 (on the runners' right) and 220'4" past (S of) the start line.

**Mile 11:** [40.660171, -73.964017](#) | On East Drive, near the NE corner of the intersection with Lincoln Rd/E Lake Dr (which becomes Well House Dr). 12 feet before (S of) the traffic signal on the NE side of said intersection (runners' right) with the green box attached labeled "Post 14". Even with the yellow equestrian sign on the runners' left.

**Mile 12:** [40.669909, -73.971275](#) | On West Dr, before (N of) the *Garfield Tot Lot*. 55 feet after (S of) L.P. #S2-13 (on the runners' right). Said L.P. has a yellow "Crosswalk Ahead" sign attached to it.

**20 km:** [40.664209, -73.973904](#) | On West Dr, before (N of) *The Tennis House*. 44'5" before (N of) L.P. #T211 (on the runners' right) and 82 feet after (S of) L.P. #T210 (on the runners' left).

**Mile 13:** [40.658742, -73.973481](#) | On West Dr, before (N of) Center Drive. 9 feet before (N of) L.P. #E246, which is on the runners' right.

**FINISH:** [40.658933, -73.971784](#) | On Center Dr, after (NE of) the turn from West Dr. 49'11" past (NE of) the leading (SW) edge of the unmarked light pole (L.P.) on the runners' right. 15'6" before (SW of) the center of the black fire hydrant and 59'11" before (SW of) the leading (SW) edge of L.P. #H205, both of which are on the runners' right (SE side of the road). Marked with MagNail on both sides of the road. Please see the detail diagram on the primary course map.