



NYCRUNS

WIN YOUR RACE

See Supplemental Page for Intermediate Splits Details.



USATF Certificate

NY23087DNB
Effective: 11/06/2023
Through: 12/31/2033



WA & AIMS Certified
USA-2023-325
Certification Expires Dec 31/2028

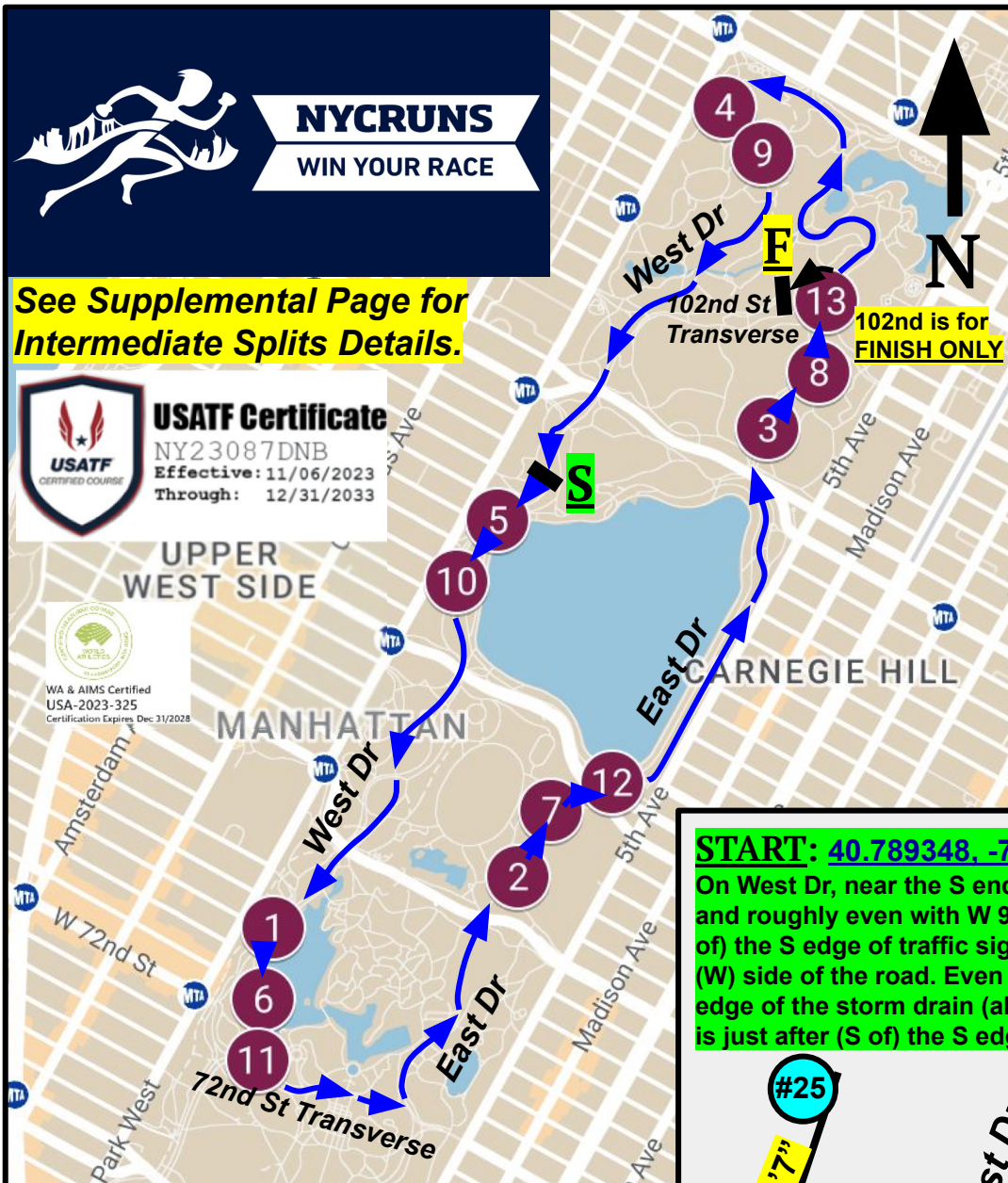

NYCRUNS Big Apple Half Marathon

New York, NY | 21.0975 km

Measured by Matthew Slocum (WA-B) + James Gusmer
24 October 2023 | precisioncoursedesign@gmail.com

Except as noted in the Course Restrictions, this course was measured using the full width of the road and the shortest possible route.

Course Restrictions (must be delineated):

Runners are restricted to the inside (left) rec lane plus the full center lane on West Dr between the Start Line and 72nd St.

All other portions of the course on East Dr and West Dr are restricted to the inside 1.5 lanes (rec lane plus half of the center lane).

72nd St Transverse and 102nd St Transverse are unrestricted.

These restrictions apply on all loops.

START: 40.789348, -73.964154

On West Dr, near the S end of the Tennis Center and roughly even with W 93rd St. 11'7" past (S) the S edge of traffic signal #25 on the right (W) side of the road. Even with the leading (N) edge of the storm drain (also on the right) that is just after (S of) the S edge of the crosswalk.

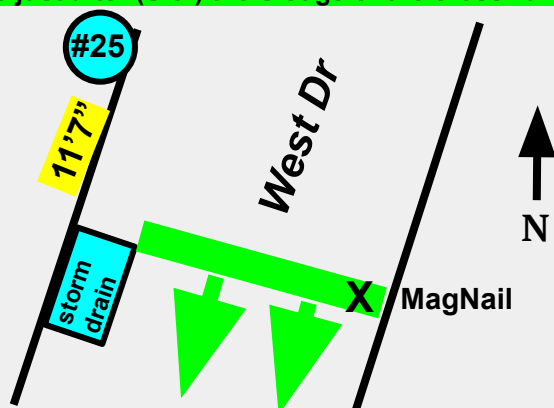

FINISH: 40.794137, -73.956406

On the 102nd St Transverse, directly even with the leading (E) edge of Light Pole (L.P.) #C0209 on the right (N) side of the road. Said L.P. is 51'3" before (E) of the black fire hydrant (also on the right (N) side of the road).

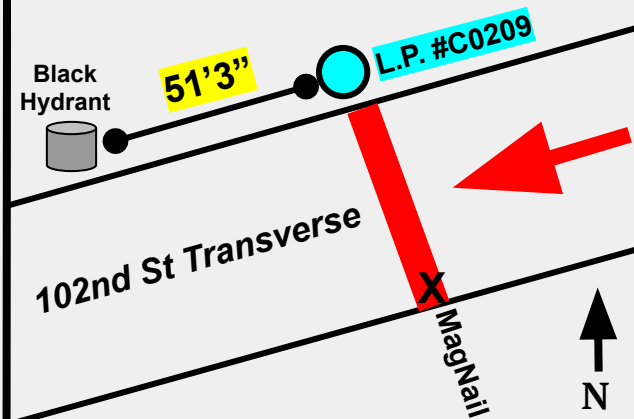

This course is run entirely within Central Park. Runners complete two loops (each is "Start to Start" via West Dr, 72nd St, and East Dr), then a partial 3rd loop. On the partial 3rd loop only, runners turn left onto the 102nd St Transverse for the Finish. 102nd is used only for the Finish.

NYCRUNS Big Apple Half Marathon | Intermediate Splits

START: [40.789348, -73.964154](#) | On West Dr, near the S end of the Tennis Center and roughly even with W 93rd St. 11'7" past (S of) the S edge of traffic signal #25 on the right (W) side of the road. Even with the leading (N) edge of the storm drain (also on the right) that is just after (S of) the S edge of the crosswalk. **See primary map for detail diagram.**

FINISH: [40.794137, -73.956406](#) | On the 102nd St Transverse, directly even with the leading (E) edge of Light Pole (L.P.) #C0209 on the right (N) side of the road. Said L.P. is 51'3" before (E of) the black fire hydrant (also on the right (N) side of the road). **See primary map for detail diagram.**

MILE 1 | [40.777924, -73.973598](#) | On West Dr, 7' past (S of) L.P. #W7501, which is on the right (W) side.

MILE 2 | [40.779261, -73.965407](#) | On East Dr, 43'5" past (N of) L.P. #E8002 (on the left (W) side).

MILE 3 | [40.790677, -73.956946](#) | On East Dr, 42'8" past (N of) L.P. #E9802 (on the left (W) side).

5K | [40.791880, -73.955519](#) | On East Dr, 39'3" before (S of) L.P. #E0101 (on the left (W) side).

MILE 4 | [40.798842, -73.958428](#) | On West Dr, near the NW corner of the park. 38'4" before (S of) L.P. #W0702, which is on the right (W) side. 19'9" past (N of) the trailing (N) edge of the storm drain.

MILE 5 | [40.788321, -73.966095](#) | On West Dr, 22'6" past (S of) L.P. #W9102 (on the right (W) side).

MILE 6 | [40.776142, -73.973973](#) | On West Drive, 30'1" past (S of) L.P. #W7222 (on the right (W) side).

10K | [40.773864, -73.972781](#) | On the 72nd St Transverse, between West Dr and Bethesda Terrace. 55'3" before (W of) L.P. #W7209 (on the left (N) side).

MILE 7 | [40.780942, -73.964261](#) | On East Dr, 16'7" past (N of) L.P. #E8301 (on the left (W) side).

MILE 8 | [40.792089, -73.955260](#) | On East Dr, 46'7" before (S of) L.P. #E0102 (on the left (W) side).

MILE 9 | [40.797688, -73.957086](#) | On West Dr, 51'9" before L.P. #W0607 (on the right (W) side).

15K | [40.794124, -73.959815](#) | On West Dr, just past (S of) 102nd St. 2' before (N of) the N edge of the NYC Electrical Box in the grass on the right (W) side. 6'6" after (S of) traffic signal #21 (also on the right).

MILE 10 | [40.786780, -73.967426](#) | On West Dr, 39'7" before (N of) L.P. #W8802 (on the left (E) side).

MILE 11 | [40.774537, -73.974151](#) | On the 72nd St Transverse, just E of West Dr. 2'6" past (E of) L.P. #W7204, which is on the right (S) side.

MILE 12 | [40.781676, -73.962154](#) | On East Dr, 5'2" before (S of) L.P. #E8502 (on the left (W) side).

20K | [40.786288, -73.957488](#) | On East Dr, 21'6" before (S of) L.P. #E9301 (on the left (W) side).

MILE 13 | [40.793920, -73.954972](#) | On East Dr, just before (S of) the 102nd St Transverse. 46'11" before (S of) L.P. #E0304 (on the left (W) side).